



Press release

11 May 2015

Vossloh Kiepe opts for new engineering track **Acceleration of development processes with modern software platform**

The rail engineering company Vossloh Kiepe GmbH switches to collaborative, database-driven engineering. In order to consolidate different disciplines in a project planning tool, the company decided to immediately use the software platform Engineering Base (EB) from Aucotec extensively for planning, designing, documentation and maintenance.

"We expect significantly more consistency and efficiency with the new system", explains Markus Dorlöchter, Head of Rail Systems Engineering at Vossloh Kiepe, who was a crucial figure in the decision-making process. "We also assume that we will have a stable, future-proof system for at least the next 10 years", says Dorlöchter.

Interdisciplinary

The pressure to shorten project lead times and meet the increased requirements due to the continuously growing complexity of electrically-powered rail and road vehicles led Vossloh Kiepe to instigate the switch. The new system has replaced two tools: on the one hand, an ECAE tool from Aucotec and, on the other hand, a wiring editor developed by Vossloh.

By changing to just one interdisciplinary software program, those involved in circuit diagram design and vehicle wiring can work in a common database. "This reduces tool changes and shortens project lead times", says Dorlöchter. This new approach requires the multi-user capability of EB, which was an important criterion in the decision-making process. Vossloh Kiepe also valued the user-friendly, intuitive handling.

New consistency

EB can be used in future to create documents from system development via production and vehicle documentation to commissioning and maintenance. Furthermore, the openness of EB facilitates the integration of workflows, tools and processes. "Whether our own configuration management or requirements engineering, existing PLM systems or IT administration is involved, connections and integration can be achieved rapidly and almost seamlessly", explains the Head of Engineering.

The option of working graphically or in lists and the ability to have any generated information visible immediately in the other view are regarded as an additional advantage by Vossloh Kiepe. The new clarity of even highly complex circuit functions is also extremely user-friendly.

"Aucotec has already been able to implement a number of our requirements with existing EB standard solutions, and individual developments are being added continuously. The project support is very professional", says Markus Dorlöchter.

"Vossloh Kiepe is very important to us as a customer because it is an innovative traditional company. We are particularly pleased that we can now extend our long-standing collaboration and that the creation of EB's interdisciplinary synergy and future viability have won over yet another global player", explained Aucotec Executive Officer Markus Bochynek upon signing the contract.

Images:



[Vossloh Kiepe tram](#)



[Roof container of traction and wiring harness equipment](#)

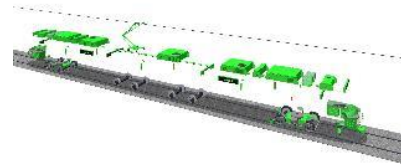

[Overview of the typical vehicle equipment of a railcar](#)



[Cabinet for vehicle control](#)

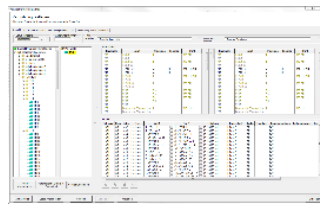

[Alphanumeric wiring editor](#)

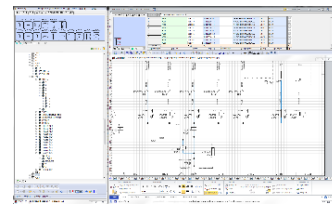

[Explorer with drawing](#)



[Markus Dorlöchter, Head of Rail Systems Engineering at Vossloh Kiepe](#)



[Marcus Bochynek, Executive Officer at Aucotec AG](#)

If printed, we would appreciate receiving a copy. Thank you very much!

AUCOTEC AG, Oldenburger Allee 24, 30659 Hannover
Press and Public Relations, Johanna Kiesel (jki@aucotec.com)

Vossloh Kiepe is globally synonymous with innovative, expert solutions in the field of traction, wiring harness and system equipment for electrically-powered rail and road vehicles. The retrofitting of older vehicles with the latest technology, assembling and commissioning and the sale of electrical components complete the range of services provided. Around 700 employees now work at the company headquarters in Düsseldorf and at their international subsidiaries. Electrical equipment from Kiepe is used all over the world. Since 2003, Vossloh Kiepe has been part of the Vossloh Group.

Aucotec AG has over 30 years of experience in developing engineering software for the entire life cycle of machines, plants and mobile systems. The solutions range from flow diagrams through control and electrical engineering for large-scale plants to modular harness design in the automotive industry. Aucotec software is in use all over the world. In addition to its headquarters in Hanover, Aucotec AG operates six further sites in Germany as well as subsidiaries in China, France, the United Kingdom, Italy, Austria, Poland, Sweden and the US. A global network of partners ensures local support throughout the world.